

COME ABOARD.
EXPERIENCE A BLESSED LIFE.

PLATINUM
East Woods
REDEFINING LUXURY

A LUXURY DEVELOPMENT BY

 **PLATINUM NARYA**

RERA : PRM/KA/RERA/1251/446/PR/100423/005855

LOCATED @ KANNAMANGALA, WHITEFIELD, BENGALURU.

www.platinumeastwoods.in

IT'S A NEW PLACE OF PRIDE. AND FOR YOU, A NEW ADDRESS TO FLAUNT

Platinum East Woods offers an exceptional setting where every day is a wonderful experience. Discover the thematic Platinum East Woods that turn your life around, enriching every waking moment of your life. Complementing the amazing lifestyle are the thoughtfully planned living spaces with designer fittings and floorings.

Luxury Community Living
amidst 1 Tower of 10 storeys



Spacious 2, 3 & 4 BHK Boutique Luxury Homes



20+ Luxury Amenities



178 Premium Units



Homes with World-Class Embellishments



2 Acres 4 Guntas Land



Top-of-the-line Flooring, Fixtures & Finishes



Extravagant Lifestyle & Wellness Features

PLATINUM
East Woods
REDEFINING LUXURY

WHERE EACH DAY
WAKES UP WITH A NEW BLESSINGS

PLATINUM
East Woods
REDEFINING LUXURY



THE EPITOME OF LUXURY LIVING
**OFFERING A WORLD OF
 COMFORT AND CONVENIENCES**



MASTER PLAN LEGEND

- | | | | |
|-----------------------------|----------------------------|---------------------|------------------------|
| 01 ENTRANCE AND EXIT GATE | 08 INDOOR GAMES | 15 KIDS PLAY AREA | 22 OPEN GYM / YOGA |
| 02 WATER FOUNTAIN | 09 OPEN AIR WORK SPACE | 16 SAND PIT | 23 SKATING RINK |
| 03 DRIVE WAY | 10 TERRACE SWIMMING POOL | 17 MARGOSA GARDEN | 24 HAMMOCK GARDEN |
| 04 OUTDOOR SEATING AREA | 11 TERRACE POOL DECK | 18 TEMPLE | 25 GARBAGE CONVERTER |
| 05 HOME THEATRE | 12 REFLEXOLOGY GARDEN | 19 FLOWER GARDEN | 26 TRANSFORMER |
| 06 PARTY HALL | 13 BARBEQUE PITS | 20 SEATING | |
| 07 GYM | 14 SENIOR CITIZEN PARK | 21 CRICKET NET | |





TYPICAL FLOOR PLAN
AREA STATEMENT IN SFT



NO	1	2	3	4	5	6	7	8	9	10	11	12	13	14	15	16	17	18
CA	1357.56	945.08	937.11	937.11	932.59	764.14	767.90	764.14	764.46	1263.37	680.93	806.98	927.10	885.55	1075.97	1270.80	1161.22	1705.77
BA	1715.03	1118.91	1109.52	1109.52	1104.82	935.28	939.16	935.93	935.93	1673.30	808.70	999.22	1093.62	1049.49	1247.12	1448.30	1331.61	1982.73
SBA	2230	1455	1442	1442	1436	1216	1221	1217	1217	2175	1051	1299	1422	1364	1621	1883	1731	2578
TYPE	4BHK+4T	3BHK+2T	3BHK+2T	3BHK+2T	3BHK+2T	2BHK+2T	2BHK+2T	2BHK+2T	2BHK+2T	3BHK+3T	2BHK+2T	2BHK+2T	3BHK+2T	2BHK+2T	3BHK+3T	3BHK+3T	3BHK+3T	4BHK+HO+5T
FACING	NORTH	WEST	WEST	WEST	WEST	NORTH	NORTH	NORTH	NORTH	NORTH	EAST	EAST	EAST	EAST	EAST	EAST	EAST	EAST

Note: CA: Carpet Area, BA: Built-up Area, SBA: Super Built-up Area

PLATINUM
East Woods
REDEFINING LUXURY

THE LANDMARK OF PREMIUM LIFESTYLE WITH
**A WORLD OF COMFORT
AND CONVENIENCES**

Step in and discover a beautiful planned layout adorned by designer flooring. You'll also find the bathrooms with stylish fitting showcasing a fine taste. And when you look outside your windows, you'll find the view, simple breathtaking. It's just like your dream home or better

A LIFESTYLE PRIVILEGES ONLY A FEW ARE BLESSED WITH

Extravagant Lifestyle & Wellness Features



Modern Gymnasium



Landscape Gardens & Green Walkways



Spacious Vastu Compliant Living Spaces



Master Bedroom with Wooden Flooring



Artistic Bath Concepts



Modern Kitchen Layout



Hi-speed Elevators



24x7 Secured Gated Community



2 Level Spacious Parking System



Utilitarian Design for Space Optimization

PLATINUM
East Woods
REDEFINING LUXURY

RESIDENCES THAT GIVE YOUR FAMILY A BLESSED LIFE

Experience class, elegance, luxury and magnificence as you enter in your dreams of Platinum East Woods. facing the main road the Hi-Rise apartment is stunning in design. You can be assured of 24/7 security and the very best of facilities. The apartment is well ventilated, vastu compliant and offer lovely views of the grounds. It is such a healthy world for your children's to grown up and spread their wings.



LUXURY AMENITIES

Enjoy an active lifestyle everyday at Platinum East Woods. It offers you the contemporary lifestyle you had always imagined. Now, you and your family can indulge in a host of amenities on offer, right next door to your home.

A HOST OF LEISURE AVENUES



Grand Entrance Plaza



Swimming Pool



Kids Play Pool



Barbeque Pits



Senior Citizen Park



Kids Play Area



Flower Garden



Margosa Garden



Hammock Garden



Terrace Garden



Reflexology Garden



Outdoor Seating



Indoor Gym



Indoor Games

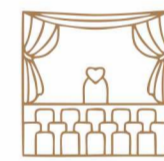

Home Theatre



Sand Pit



Cricket Net



Open Gym



Party Hall



Temple



Visitor's Parking



Yoga



Skating Rink



Jogging Track



CCTV Surveillance

DIVE INTO LUXURY EXPERIENCE WITH TERRACE SWIMMING POOL



ELEVATED SERENITY: UNWIND IN EXCLUSIVE TERRACE SWIMMING POOL

Discover a sanctuary in the sky with exceptional terrace swimming pool, a luxurious retreat where leisure meets breathtaking vistas. Immerse yourself in the pristine waters while soaking in panoramic views that redefine your sense of relaxation. Whether it's a rejuvenating morning swim or a twilight escape under the stars, our terrace pool offers a private haven above the city hustle.

PLATINUM
East Woods
REDEFINING LUXURY



OUTDOOR AMENITIES

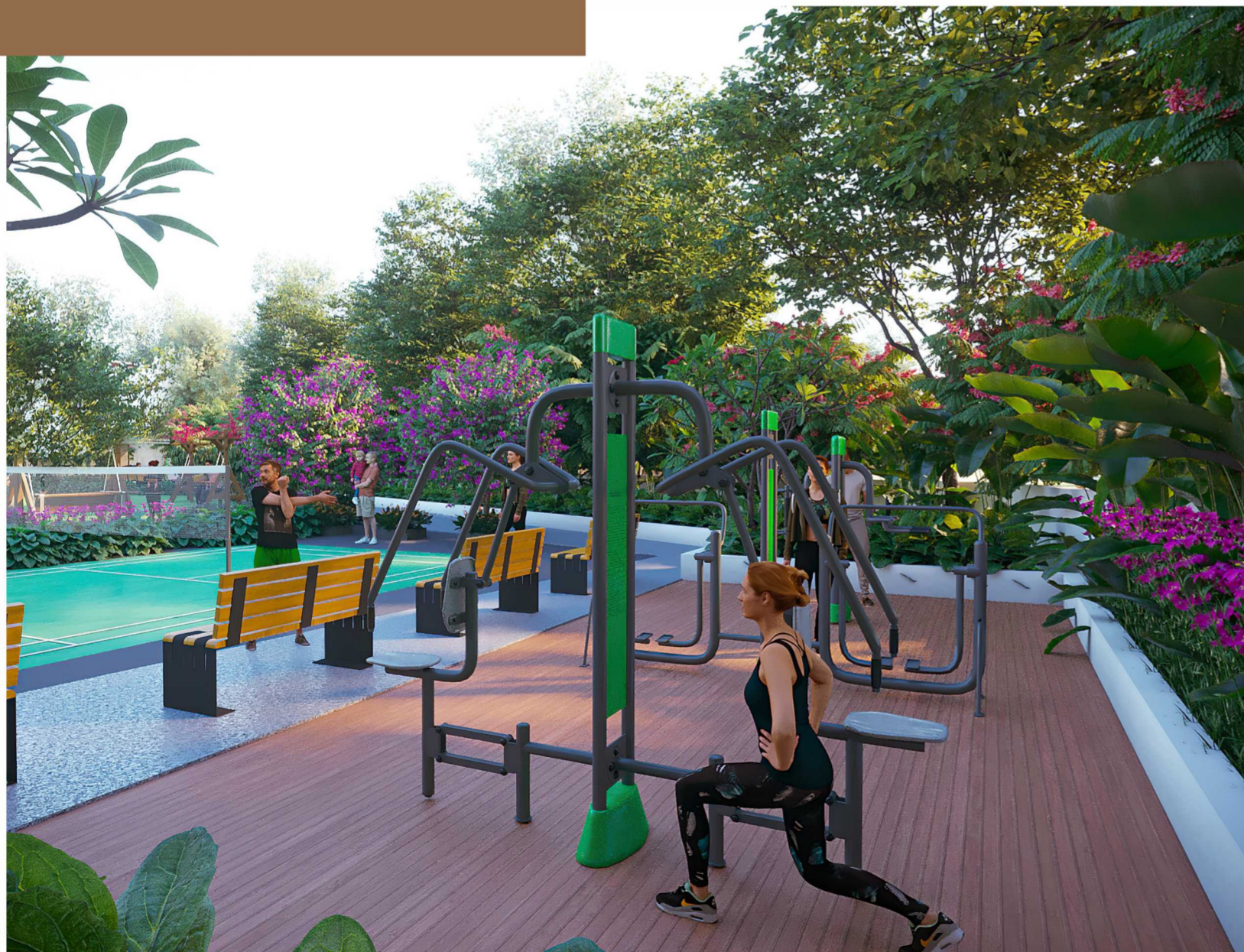

UNMATCHED OUTDOOR BLISS: A HAVEN OF RECREATION FOR EVERY AGE

Embrace a lifestyle that seamlessly blends recreation and relaxation. Our outdoor amenities cater to every age, ensuring that each day brings new opportunities for enjoyment and well-rounded living. Welcome to a community designed for active, vibrant, and joyful living.



PLATINUM
East Woods
REDEFINING LUXURY



INDOOR AMENITIES



INDOOR EXTRAVAGANZA: ELEVATE YOUR LIFESTYLE WITH EXCLUSIVE AMENITIES

Indulge in the epitome of indoor opulence. Each amenity is crafted to enhance your lifestyle, providing a perfect balance of leisure, fitness, and social engagement. Welcome to a home where every corner is designed for your ultimate comfort and enjoyment.



PLATINUM
East Woods
REDEFINING LUXURY

A WORLD OF SMILE AND ADVENTURE FOR THE SMALL & YOUNG

Since childhood we have been playing all sorts of sports. But once we are grown up, we always feel like playing but don't either time or place. It's time to relive your growing-up years and quench your thirst for sports at the Sports courtyard



THE LOCATION

Whitefield is a magnet for retail development in Bengaluru. Affluent Individuals and ambitious businesses are all moving towards Whitefield. Platinum East Woods represents this luxury lifestyle for our Home Owners. Your commute to work is likely to go short and sweet from our location and the weekend outings will feel as easy as they should.

EDUCATIONAL INSTITUTIONS

- Jain Heritage School : Walkable
- NPS ITPL : 1.8 Km
- Chrysalis High : 1.8 Km
- Silver Oak Int. School : 1.8 Km
- Vagdevi Vilas School : 2.1 Km
- NPS Whitefield : 3.2 Km
- Valistus Int.School : 3.9 Km
- New Baldwin Int. : 6.8 Km
- M V J College : 7.2 Km
- Garden City University : 9.1 Km

HOSPITALS

- Aaxis Hospital : 2.4 Km
- Miracle Hospital : 2.5 Km
- East Point Hospital : 7.7 Km
- Swastha Hospital : 8.7 Km
- CloudnineHospital : 9 Km
- Manipal Hospital Varthur : 9.2 Km
- Manipal Hospital ITPL : 9.3 Km
- Aster Women & Children : 9.6 Km
- Vydehi Hospital : 10.8 Km

ENTERTAINMENT

- Mini Lalbaug : 100 Mtrs
- Rolla Hyper Market : 2.5 Km
- Inox : 2.6 Km
- Red Rhino Restaurant : 2.6 Km
- Orion Uptown Mall : 4.1 Km
- Decathlon : 5.8 Km
- Nexus Whitefield : 8.2 Km
- The Forum Neighbourhood : 8.2 Km

IT PARKS

- BGRT : 2.4 Km
- Brigade Signature Towers : 3.1 Km
- ITPL : 7.09 Km
- Bagmane Business Center : 16 Km
- RMZ Infinity : 16.8 Km

TRANSPORT HUB

- Bangalore Airport : 28.7 Km
- K R Puram Railway Station : 13.9 Km
- Whitefield Railway Station : 4.4 Km
- Kadugodi Metro Station : 3.5 Km

PLATINUM East Woods

REDEFINING LUXURY

Location Map (Not to Scale)

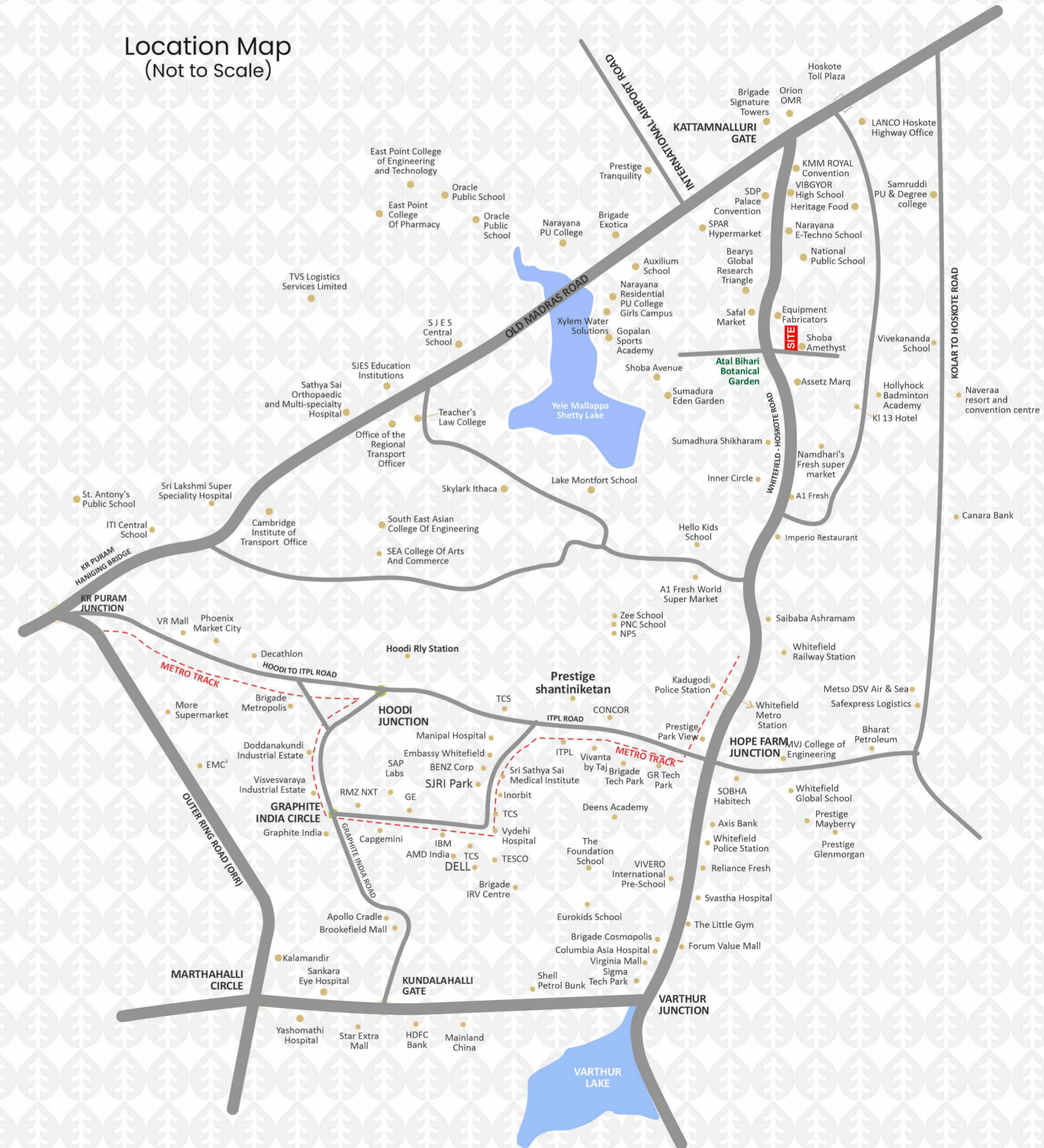



A PREMIUM LIFE DESIGNED WITH LEISURE AVENUES YOU ALWAYS DREAMED OF

Indulge in the epitome of luxury living with our Platinum East woods offering, meticulously designed to fulfill your dreams of a leisure-filled life. Our opulent residences redefine sophistication, offering a seamless blend of comfort and style. Enjoy exclusive amenities, from state-of-the-art home gyms to spa retreats, ensuring a holistic approach to well-being. Elevate your living experience – welcome to a realm where every moment is designed for indulgence and fulfilment.

PLATINUM
East Woods
REDEFINING LUXURY

LIFESTYLE PRIVILEGES ONLY A FEW ARE BLESSED

STRUCTURE & SUPERSTRUCTURE

RCC FRAMED WITH 6 inches of outer wall
4 inches internal walls

PLASTERING:- External and internal coat cement plaster

PAINTING:

Double coat painting for internal & external Asian Paints /
Apex Ultima or Equivalent

DOORS, WINDOWS & RAILINGS:

Main Door:- 8' Height Engineer wood Teak veneer laminated door

Internal doors:- Engineer wood Teak veneer laminated doors

FLOORING:

2.5'X5' vitrified tiles for all Bedrooms
(Exxaro, Aparna, Kajaria or Equivalent)

Master Bedroom: Wooden Texture Tiles

Toilet :- 2'X4' Acid resistance anti skid of reputed make
and dado up to door height.

Utility & Balcony:- Acid resistance anti skid of reputed make.
Dado upto 4' height in Utility.

Staircase :- Natural stone / Tiles flooring with
edge chamfering / polish.

Corridor:- Anti skid Double charged tiles.

Kitchen:

Provision for designer modular kitchen. Electrical points to suit
the electrical appliances needed in the kitchen.

Provision for water purifier, exhaust fan / chimney.

Provision for washing machine in the Utility area

SPECIFICATIONS

ELECTRICAL AND COMMUNICATION:

Cables:- FRLS Concealed copper wiring of Anchor

Switches:- Modular switches in all rooms of Anchor

AC:- Power outlet provision in Master Bedroom, Living area.

Power outlet provision for Geyser, Exhaust fan in all toilets.

Kitchen:- Power plug for cooking range, chimney, refrigerator,
microwave oven, mixer / grinder.

PLUMBING AND SANITARY:

*Concealed flush with Wall mounted concealed flush tank
Grohe / Duravit or equivalent

*Wash basin in all toilets and provision for Dining area.

*All water lines are Supreme and drainage lines are PVC of
Supreme / equivalent make

* Hot and cold water wall Diverter with shower.

*Provision for geyser in all toilets.

ELEVATORS/LIFTS

Automatic passenger, Service lifts of Kone / Schindler /
Equivalent brand with front tiles cladding.

GENERATOR

1KV DG BACK UP

STP, Rainwater Harvesting & Fire Safety Equipments



ABOUT PLATINUM NARYA

A PRESTIGIOUS LANDMARK BROUGHT TO YOU BY RENOWNED DEVELOPERS

PLATINUM NARYA has been a dream to individuals with two decades of experience in the construction industry. Our objectives are "QUALITY CONSTRUCTION" "MORE VALUE FOR MONEY" With this vision and strategic planning, we deliver what we promise. Quality in every detail of work, at each level and continuous innovation are what sets us apart from the rest of the builders in the country.

PLATINUM NARYA is one recognized name in the Bengaluru real estate sector. Its been a name that has been synonymous with quality homes and aesthetic lifestyles. Construction has been its core competency and PLATINUM NARYA is known for delivering on time, every time.

PLATINUM NARYA, with specialization in the areas of construction and property development. As a leading developer, we are always keen to maintain quality by selecting premium fixtures and branded construction materials with aesthetic interior and exterior finishing. This is evident from the fact that most of PLATINUM NARYA apartments get sold much before the foundation is laid.

PLATINUM NARYA

Sy. No. 80/2, Kembathalli Village, Near KRB Indian Oil Petrol Bunk ,
Classic Pleasant Ville Layout, Anjanapura 10th Block,
J.P. Nagar, 9th Phase, Bengaluru - 560 108.

Site Address

Sy. No. 191, Kannamangala Village,
Bengaluru East Taluk, Bengaluru - 560 067.

CALL: 63669 55424
sales@platinumeastwoods.in
www.platinumeastwoods.in

RERA : PRM/KA/RERA/1251/446/PR/100423/005855